

PROJECT NAME: \_\_\_\_\_ CUSTOMER: \_\_\_\_\_

APPLICATION:  INTERIOR  EXTERIOR FINISH: \_\_\_\_\_ NB JOB #: \_\_\_\_\_

## SINGLE-LEAF DOOR SPECIFICATIONS

DOOR No.	DOOR SWING	WINDOW OPTION	INSTALLATION OPTION	CLEAR OPENING WIDTH	CLEAR OPENING HEIGHT	ROUGH OPENING WIDTH	ROUGH OPENING HEIGHT	THROAT DIMENSION

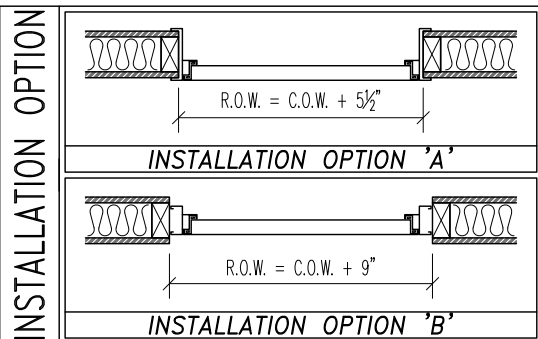
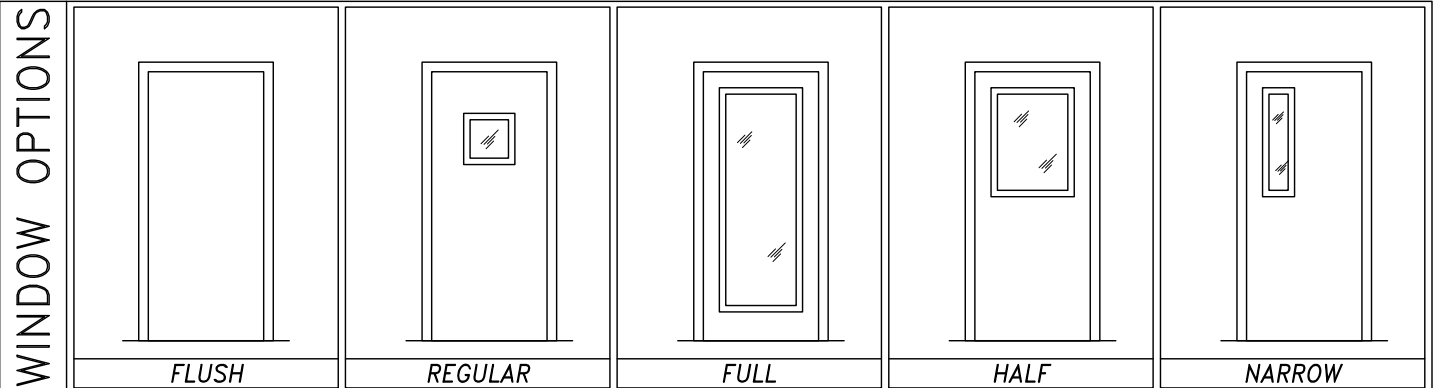
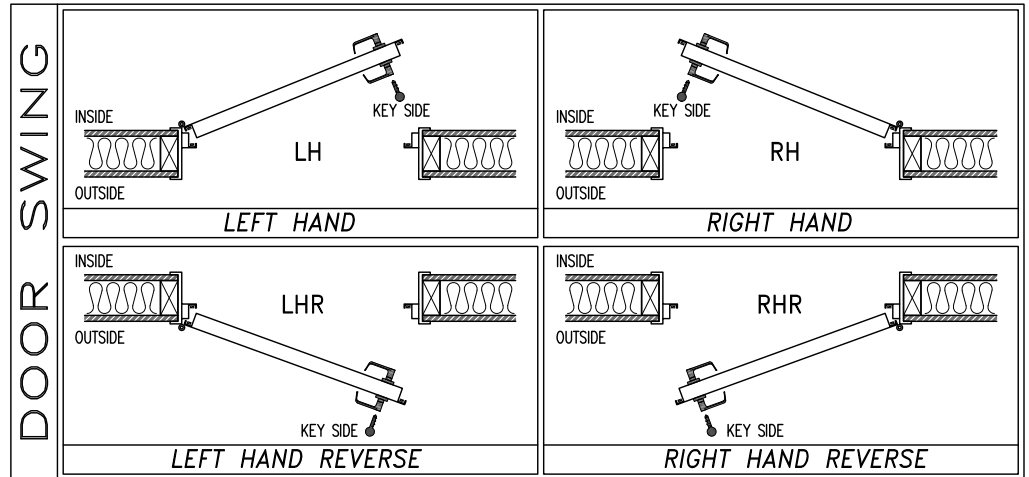
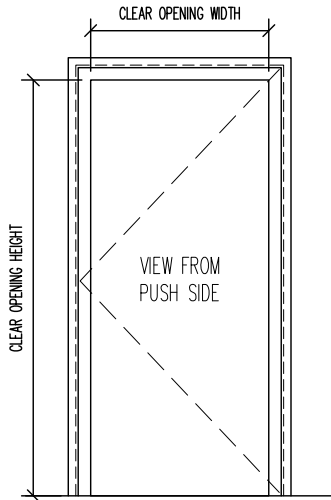

HARDWARE SCHEDULE		
HINGES	NBL-CLH-100 OFFSET CAM-LIFTING HINGES (QTY. (2) PER LEAF / FINISH: DULL SILVER)	QTY. 2
THRESHOLD	ONE-PIECE 1/4" ALUMINUM SILL PLATE	QTY. 1
DOOR BOTTOM	MFG. STANDARD TEFLON COATED COMPRESSION SEAL	QTY. 1
MAGNETIC SEALS	MFG. STANDARD MAGNETIC DOOR SEAL (INSTALLED @ DOOR LEAF ONLY)	17 ft.
ADA SEALS	MFG. STANDARD ADA SILICONE COMPRESSION SEAL (INSTALLED @ DOOR FRAME ONLY)	17 ft.

NOTES: 1.) SEE SHEET 'DS-29' FOR DOOR INSTALLATION DETAILS 2.) ADA SEALS NULLIFY THE OPENING FORCE REQUIRED TO BREAK THE BOND OF THE MAGNETIC SEALS.

<h3>STC-50 / ADA SINGLE-LEAF DOOR SPECIFICATIONS</h3>	PROJECT:	TYPE: GENERAL	<b>NOISE BARRIERS</b> 401 AIRPORT DRIVE NORTH AURORA, IL 60532 Phone: (847) 843-0500 Fax: (847) 843-0501 www.noisebarriers.com	
	SUBMITTED BY:	DATE:		ISSUE: -
	APPROVED BY:	DATE:		PROJECT No.:
	PROJ. MGR.	SHEET: DS-12		