

PROJECT NAME: _____ CUSTOMER: _____

APPLICATION: INTERIOR EXTERIOR FINISH: _____ NB JOB #: _____

DOOR SPECIFICATIONS

DOOR No.	DOOR SWING	WINDOW OPTION	INSTALLATION OPTION	CLEAR OPENING WIDTH	CLEAR OPENING HEIGHT	ROUGH OPENING WIDTH	ROUGH OPENING HEIGHT	WALL THICKNESS

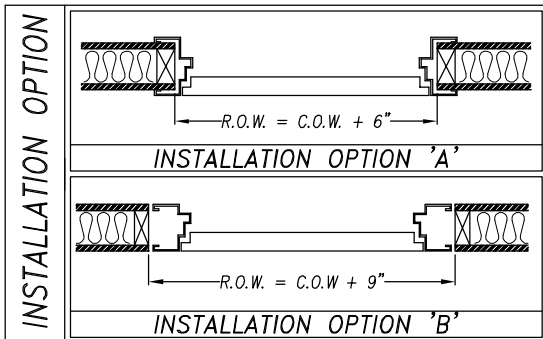
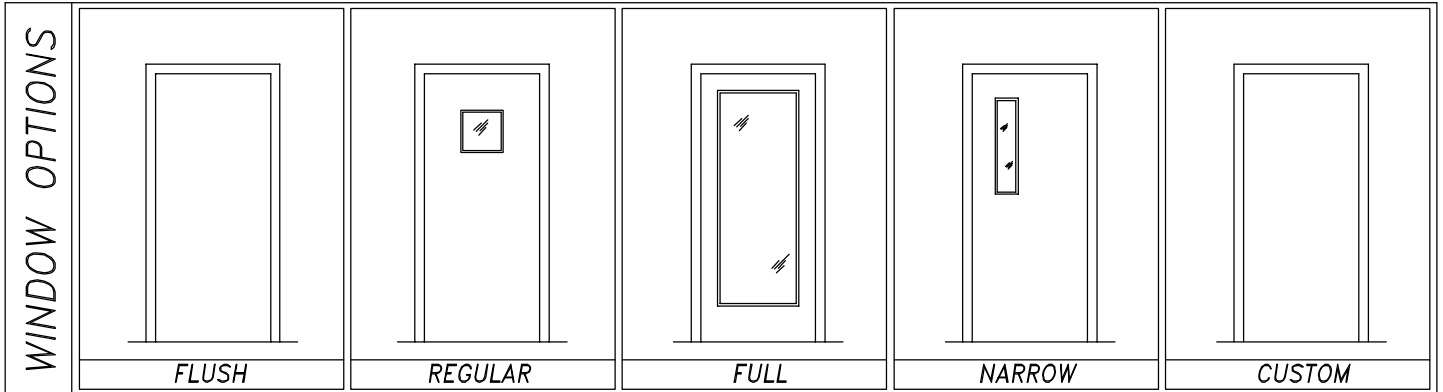
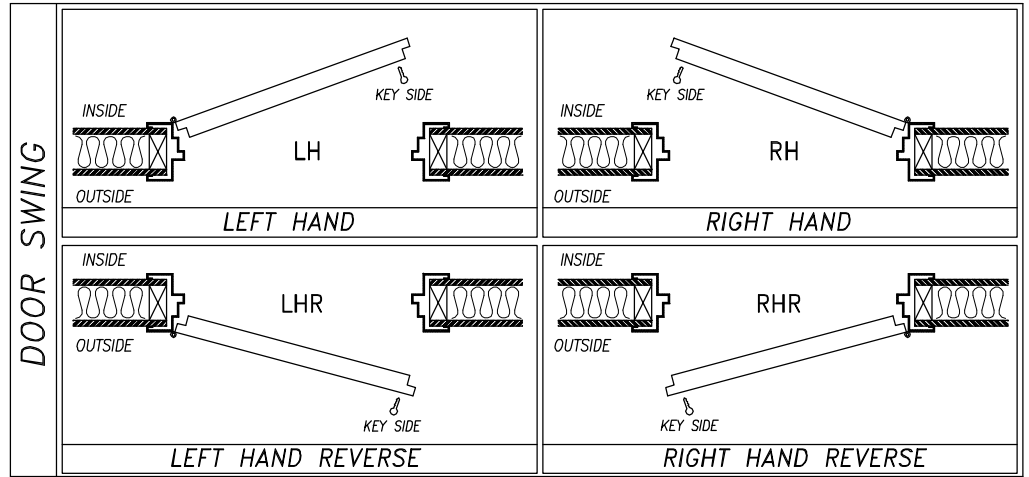
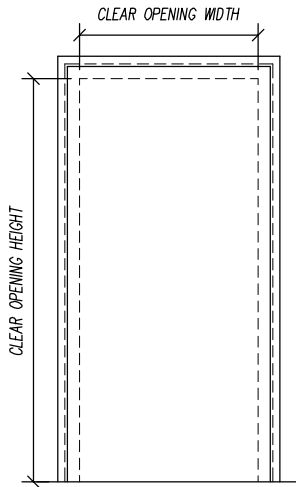

HARDWARE SCHEDULE

HINGES	MFG. STANDARD CAM-LIFT HINGES (QTY. (2) PER LEAF)
PUSH/PULL HANDLE	TRIMCO 1195-2 PUSH/PULL HANDLE (QTY. (2), BACK-TO-BACK, US260 FINISH)
THRESHOLD	ONE-PIECE 1/4" ALUMINUM SILL PLATE
DOOR BOTTOM	MFG. STANDARD TEFLON COATED DOUBLE COMPRESSION SEALS
HD/JMB/ASTRAGAL SEALS	MFG. STANDARD DOUBLE MAGNETIC SEALS

NOTES: _____

**STC-52
SL-DOOR
SPECIFICATIONS**

PROJECT:	TYPE:	
SUBMITTED BY:	DATE:	ISSUE:
APPROVED BY:	DATE:	PROJECT No.:
	SHEET:	

Noise Barriers, LLC
 2001 Kelley Court
 Libertyville, IL 60048
 Phone: 847-843-0500
 Fax: 847-843-0501
 www.noisebarriers.com