

PROJECT NAME: _____ CUSTOMER: _____

APPLICATION: INTERIOR EXTERIOR FINISH: _____ NB JOB #: _____

DOOR SPECIFICATIONS

| DOOR No. | DOOR SWING | WINDOW OPTION | INSTALLATION OPTION | CLEAR OPENING WIDTH | CLEAR OPENING HEIGHT | ROUGH OPENING WIDTH | ROUGH OPENING HEIGHT | WALL THICKNESS |
|----------|------------|---------------|---------------------|---------------------|----------------------|---------------------|----------------------|----------------|
| | | | | | | | | |

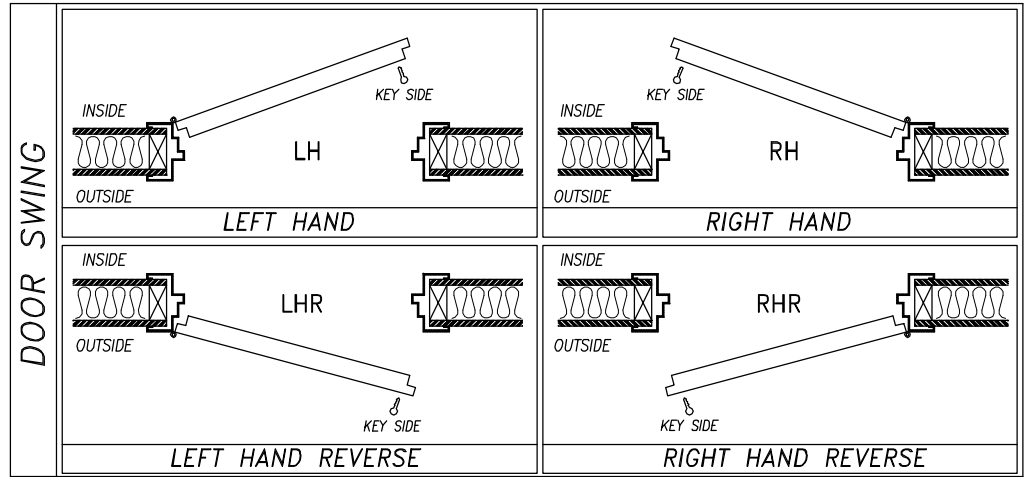
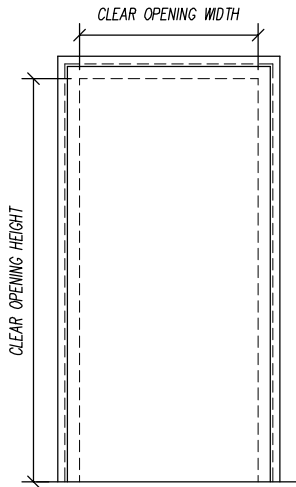

WINDOW OPTIONS

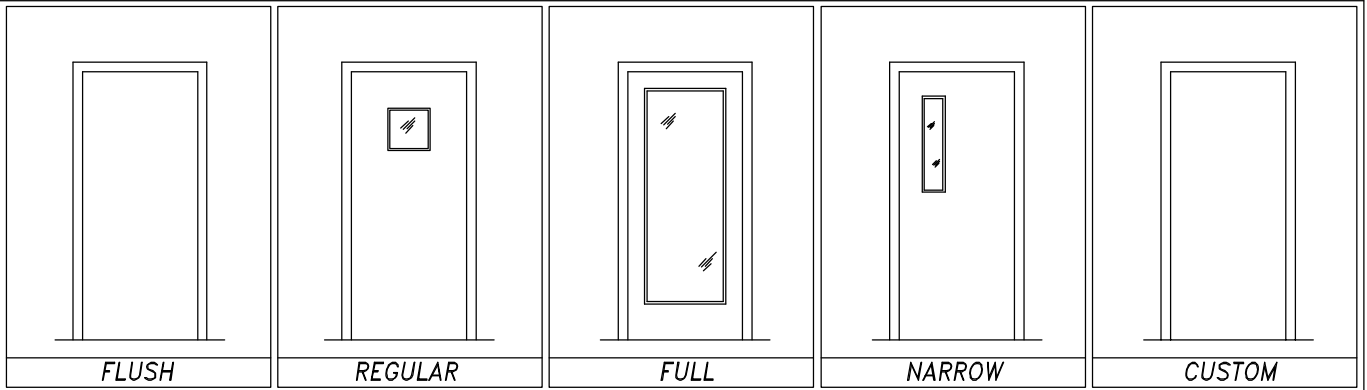

INSTALLATION OPTION

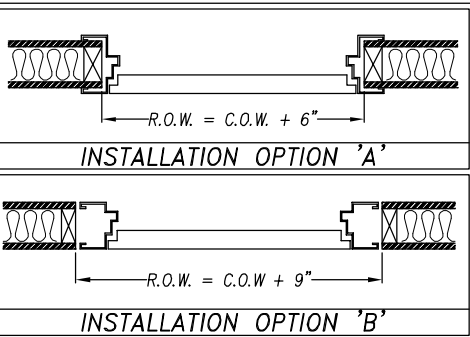

HARDWARE SCHEDULE

| | |
|-----------------------|---|
| HINGES | MFG. STANDARD CAM-LIFT HINGES (QTY. (2) PER LEAF) |
| PUSH/PULL HANDLE | TRIMCO 1195-2 PUSH/PULL HANDLE (QTY. (2), BACK-TO-BACK, US260 FINISH) |
| THRESHOLD | ONE-PIECE 1/4" ALUMINUM SILL PLATE |
| DOOR BOTTOM | MFG. STANDARD TEFLON COATED COMPRESSION SEAL |
| HD/JMB/ASTRAGAL SEALS | MFG. STANDARD DOUBLE MAGNETIC SEALS |
| | |
| | |
| | |

NOTES: _____

STC-48
SL-DOOR
SPECIFICATIONS

| | | |
|---------------|--------|--------------|
| PROJECT: | TYPE: | |
| SUBMITTED BY: | DATE: | ISSUE: |
| APPROVED BY: | DATE: | PROJECT No.: |
| | SHEET: | |

Noise Barriers, LLC

2001 Kelley Court
 Libertyville, IL 60048
 Phone: 847-843-0500
 Fax: 847-843-0501
 www.noisebarriers.com