

PROJECT NAME: \_\_\_\_\_ CUSTOMER: \_\_\_\_\_

APPLICATION:  INTERIOR  EXTERIOR FINISH: \_\_\_\_\_ NB JOB #: \_\_\_\_\_

## DOUBLE-LEAF DOOR SPECIFICATIONS

DOOR No.	DOOR SWING (ACTIVE LEAF)	WINDOW OPTION		INSTALLATION OPTION	CLEAR OPENING WIDTH	CLEAR OPENING HEIGHT	ROUGH OPENING WIDTH	ROUGH OPENING HEIGHT	WALL THICKNESS
		ACTIVE	INACTIVE						

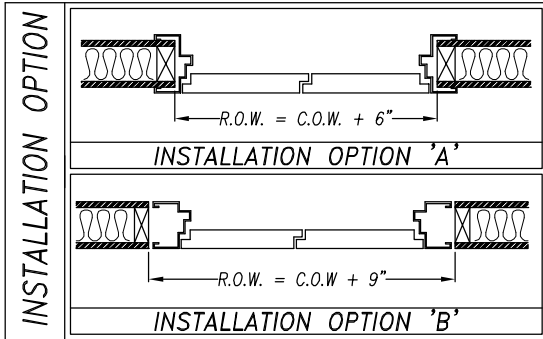
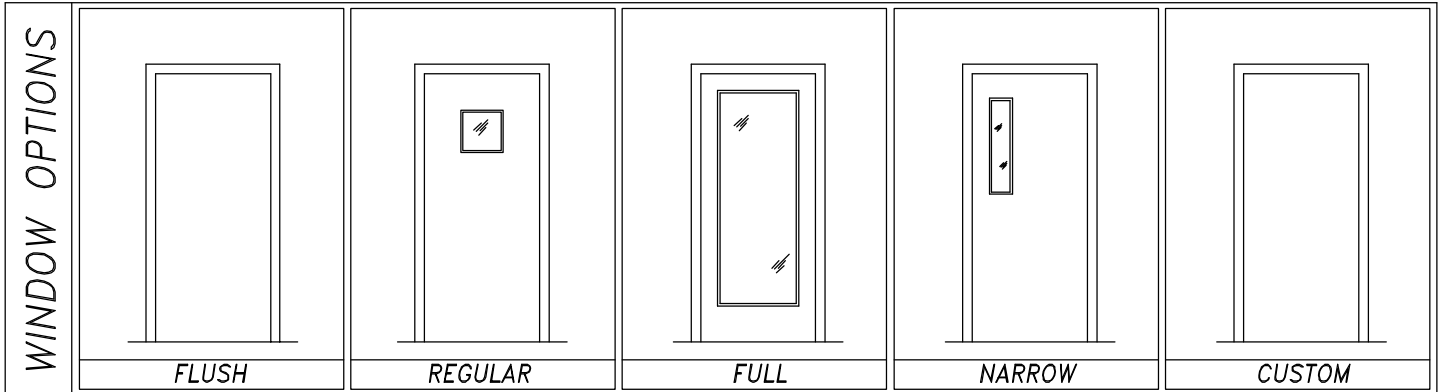
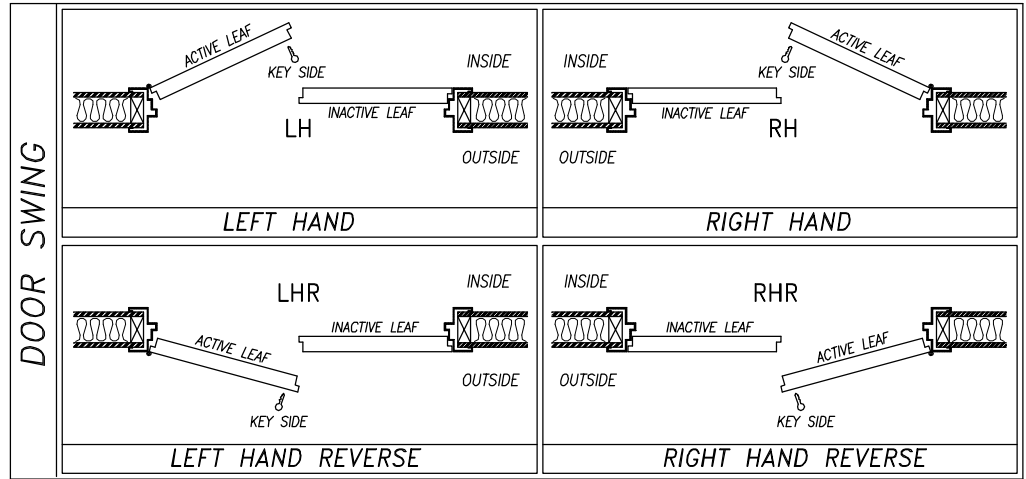
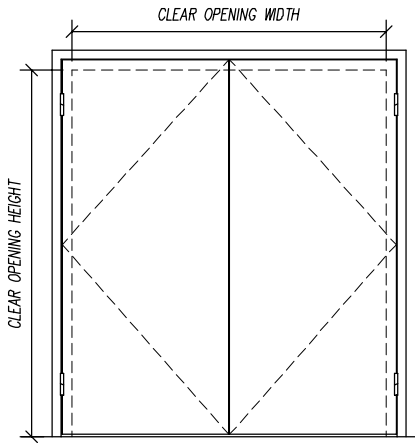

### HARDWARE SCHEDULE

HINGES	MFG. STANDARD CAM-LIFT HINGES (2 PER LEAF)
SURFACE BOLTS	MFG. STANDARD SURFACE MOUNTED SLIDE BOLTS (TOP & BOT. INACTIVE LEAF)
DOOR BOTTOM	MFG. STANDARD TEFLON COATED COMPRESSION SEAL
HEAD/JAMB SEALS	MFG. STANDARD DOUBLE MAGNETIC SEALS

NOTES: \_\_\_\_\_

<h1 style="margin: 0;">STC-48</h1> <h2 style="margin: 0;">DL-DOOR</h2> <h3 style="margin: 0;">SPECIFICATIONS</h3>	PROJECT:		TYPE:		
	SUBMITTED BY:		DATE:	ISSUE:	
	APPROVED BY:		DATE:	PROJECT No.:	
			SHEET:		

**Noise Barriers, LLC**  
 2001 Kelley Court  
 Libertyville, IL 60048  
 Phone: 847-843-0500  
 Fax: 847-843-0501  
 www.noisebarriers.com